

RISK ASSESSMENT

Venue

YSTRADGYNLAIS SWIMMING POOL, YSTRADGYNLAIS

Carried out by: *Mark Evans*

Date Risk Assessment carried out: *13.08.2020*

Review Date: *Ongoing in line with Welsh Government and Welsh Triathlon guidance*



Risk Assessment Form (GUIDANCE)



In line with British Triathlon Federation (BTF) and Government guidance Clubs and coaches in WALES are required to provide a COVID SECURE Operation including:

1. All community clubs must appoint a named COVID-19 Officer (CO).
2. All community clubs must develop a COVID-19 Action and Plan and Risk Assessment.
3. All clubs and coaches must comply with government guidance around social distancing before, during and after activity.
4. All clubs and coaches must capture pre-activity health questionnaires, including participant contact details which can be shared upon request with the government's Track and Trace initiative.
5. Clubs and coaches must ensure everyone at the session maintains good hygiene and that provisions are in place to allow for this.
6. Sessions that include children and young people under the age of 18 should be more meticulously planned to ensure their needs are catered for.

Prior to commencing club and coaching activity in line with your club action plan* please ensure you complete risk assessments for your sessions.

Please consider how you will communicate your plans with your participants, coaches, wider workforce, parents and members.

Venue:		Ystradgynlais Sport Centre / Pool	Venue Contact Name & Contact Details:	Freedom Leisure Ystradgynlais Sports Centre Craig Jones -01639 844854 craig.jones@freedom-leisure.co.uk
Address: (Include postcode)		Ystradgynlais Sport Centre Ystradgynlais, SA9 1AP		
Group:		Celtic Tri	Location of first-aider:	Venue Staff, Lifeguards poolside
Date:		Starting 20/08/2020 Thursday's Also Sunday (Temp)	Location of Defibrillator	Sports centre
Time:		6:30pm – 7:30pm Thursdays 3:00pm – 4:00 pm Sundays	Location of telephone:	Mobile phones, and poolside
Participants:	Number:	Max 30 including coaches and volunteers	Location of toilets:	Toilets will be open to swimmers. One in one out.
	Age:	Juniors under 18's	Location of changing rooms:	No changing facilities when entering the pool. Showers and changing rooms available after the session. Swimmers should attend session dressed ready for swimming.
	Ability:	experienced athletes, mix abilities	Location of first-aid kit:	Reception and poolside
Lead coach name:		Richard Clifford	Stocked and maintained:	<input checked="" type="checkbox"/> Yes <input type="checkbox"/> No
Venue documents read and understood (please ✓ appropriate box):		Normal operating procedures: <input checked="" type="checkbox"/> Yes <input type="checkbox"/> No	Additional notes:	This risk assessment will be reviewed in line with Welsh Government and Welsh Triathlon guidance, as and when it gets updated. Coaches will be actively monitoring the sessions at swimming pools and will feedback to committee at the end of each session.
		Health and safety policy: <input checked="" type="checkbox"/> Yes <input type="checkbox"/> No		
		Emergency action plan (EAP): <input checked="" type="checkbox"/> Yes <input type="checkbox"/> No		

COVID-19 Additional Considerations Risk Assessment Form

Location & Description of Hazard:	People at Risk:	Level of Risk (High/Medium/Low):	Advice Required: (from whom)	Action(s) to Mitigate/ Remove Risk:	Person responsible for resolution:	Residual Risk: After resolution	Dates Reviewed
Social distancing	All	Likelihood: Impact: MED	<input type="checkbox"/> No <input type="checkbox"/> Yes If yes, who:	<i>Controlled numbers of 10 swimmers per lane. Lanes are double width. 2 lanes available. Separate starting points for swimmers in each lane. 5 at each end of lane.</i>	Coach	Likelihood: Impact: LOW	Will monitor and follow WG and WT guidance.
Equipment	all	Likelihood: Impact: LOW	<input type="checkbox"/> No <input type="checkbox"/> Yes If yes, who:	<i>All swimmers to bring their own pool equipment. No sharing of equipment. No equipment available from venue</i>	Coach Swimmers	Likelihood: Impact: LOW	Will monitor and follow WG and WT guidance
Access points (gates/ barriers etc)	all	Likelihood: Impact: MED	<input type="checkbox"/> No <input type="checkbox"/> Yes If yes, who:	<i>There will be a one-way system in place. Swimmers will line up outside front entrance maintain 2m social distancing. On entry to venue, coach will check you in on app for track and trace purposes and ask health screening questions. Hand sanitiser will be applied/available by centre staff.</i>	Coach and centre staff Coach and centre staff	Likelihood: Impact: LOW	Will monitor and follow WG and WT guidance

Location & Description of Hazard:	People at Risk:	Level of Risk (High/Medium/Low):	Advice Required: (from whom)	Action(s) to Mitigate/ Remove Risk:	Person responsible for resolution:	Residual Risk: After resolution	Dates Reviewed
				<p><i>Following one-way system all swimmers will make their way directly to the swimming pool.</i></p> <p><i>Swimming bags/boxes to be placed at shallow end benches spaced out 2m apart.</i></p> <p><i>At the end of the session, dry down poolside and change. Coaches to escort juniors to meet parents.</i></p> <p><i>Leave premises promptly and don't hang around inside the changing rooms, reception area or outside the entrance to the venue</i></p>	All		
Swimmers keeping distance from each other and coaches	all	Likelihood: Impact: MED	<input type="checkbox"/> No <input type="checkbox"/> Yes If yes, who:	<p><i>Will be addressed before hand via communication channels with members and with swimmers before beginning of session.</i></p> <p><i>There will be 10 swimmers per double lane.</i></p>	all	Likelihood: Impact: LOW	Will monitor and follow WG and WT guidance

Location & Description of Hazard:	People at Risk:	Level of Risk (High/Medium/Low):	Advice Required: (from whom)	Action(s) to Mitigate/ Remove Risk:	Person responsible for resolution:	Residual Risk: After resolution	Dates Reviewed
				<i>Each swimmer will be told what lane to swim in based on ability and what end to start.</i>			
Permissions to use area	all	Likelihood: Impact: MED	<input type="checkbox"/> No <input type="checkbox"/> Yes If yes, who:	<i>Freedom Leisure have approved our Risk Assessment, Club will have exclusive use of the swimming pool with no risk of members of the public entering.</i>	Coaches	Likelihood: Impact: LOW	Will monitor and follow WG and WT guidance

Location & Description of Hazard:	People at Risk:	Level of Risk (High/Medium/Low):	Advice Required: (from whom)	Action(s) to Mitigate/ Remove Risk:	Person responsible for resolution:	Residual Risk: After resolution	Dates Reviewed
Participant health and ability to exercise	runners	Likelihood: Impact: MED	<input type="checkbox"/> No <input type="checkbox"/> Yes If yes, who:	<i>Participation questions will be asked when booking onto a session and when attending a session before being admitted.</i> <i>All those in attendance are experienced swimmers.</i> <i>Coaches have a good understanding of everyone's ability.</i>	Coach and volunteers	Likelihood: Impact: LOW	Will monitor and follow WG and WT guidance

Location & Description of Hazard:	People at Risk:	Level of Risk (High/Medium/Low):	Advice Required: (from whom)	Action(s) to Mitigate/ Remove Risk:	Person responsible for resolution:	Residual Risk: After resolution	Dates Reviewed
PPE for coach & participants	all	Likelihood: Impact: MED	<input type="checkbox"/> No <input type="checkbox"/> Yes If yes, who:	<i>Personal choice for coaches.</i>	Coaches	Likelihood: Impact: LOW	Will monitor and follow WG and WT guidance
Hand washing	all	Likelihood: Impact: MED	<input type="checkbox"/> No <input type="checkbox"/> Yes If yes, who:	<i>Hand sanitiser will be available at entrance of the venue for everyone to use before entering.</i>	Everyone	Likelihood: Impact: LOW	Will monitor and follow WG and WT guidance
Spectating at Coached Sessions	All	Likelihood: Impact: MED	<input type="checkbox"/> No <input type="checkbox"/> Yes If yes, who:	<i>There is no spectating at swimming sessions, until further notice</i>	Coaches and centre staff	Likelihood: Impact: LOW	Will monitor and follow WG and WT guidance
Social distancing on Arrival	All	Likelihood: Impact: MED	<input type="checkbox"/> No <input type="checkbox"/> Yes If yes, who:	<i>Maintain social distancing when arriving at swimming pool.</i>	All	Likelihood: Impact: LOW	Will monitor and follow WG and WT guidance
Social distancing on Leaving				<i>Check in when called by coaches at the entrance to swimming pool.</i> <i>Following the conclusion of the training session, swimmers / coaches / members should be encouraged to leave the facility immediately to avoid gatherings in car parks / communal areas.</i>			

Location & Description of Hazard:	People at Risk:	Level of Risk (High/Medium/Low):	Advice Required: (from whom)	Action(s) to Mitigate/ Remove Risk:	Person responsible for resolution:	Residual Risk: After resolution	Dates Reviewed
Toilets	all	Likelihood: Impact: MED	<input type="checkbox"/> No <input type="checkbox"/> Yes If yes, who:	<p><i>Toilets for adults are available but will operate a one in one out policy.</i></p> <p><i>Follow one way system when coming out.</i></p> <p><i>Toilets for juniors will use the disabled toilets poolside and will operate a one in one out policy.</i></p> <p><i>Follow one way system when coming out.</i></p>	All	Likelihood: Impact: LOW	Will monitor and follow WG and WT guidance
Changing rooms and showers	all	Likelihood: Impact: MED	<input type="checkbox"/> No <input type="checkbox"/> Yes If yes, who:	<p><i>No changing facilities will be available on arrival.</i></p> <p><i>Swimmers to be pool ready.</i></p> <p><i>At the end of the sessions, swimmers dry at poolside and get dressed. Coaches will escort juniors outside to meet parents/carers</i></p>	All	Likelihood: Impact: LOW	Will monitor and follow WG and WT guidance

Insert Diagram(s) of layout of venue with key safety elements marked (this page is intended to be shared between Risk Assessment and EAP):

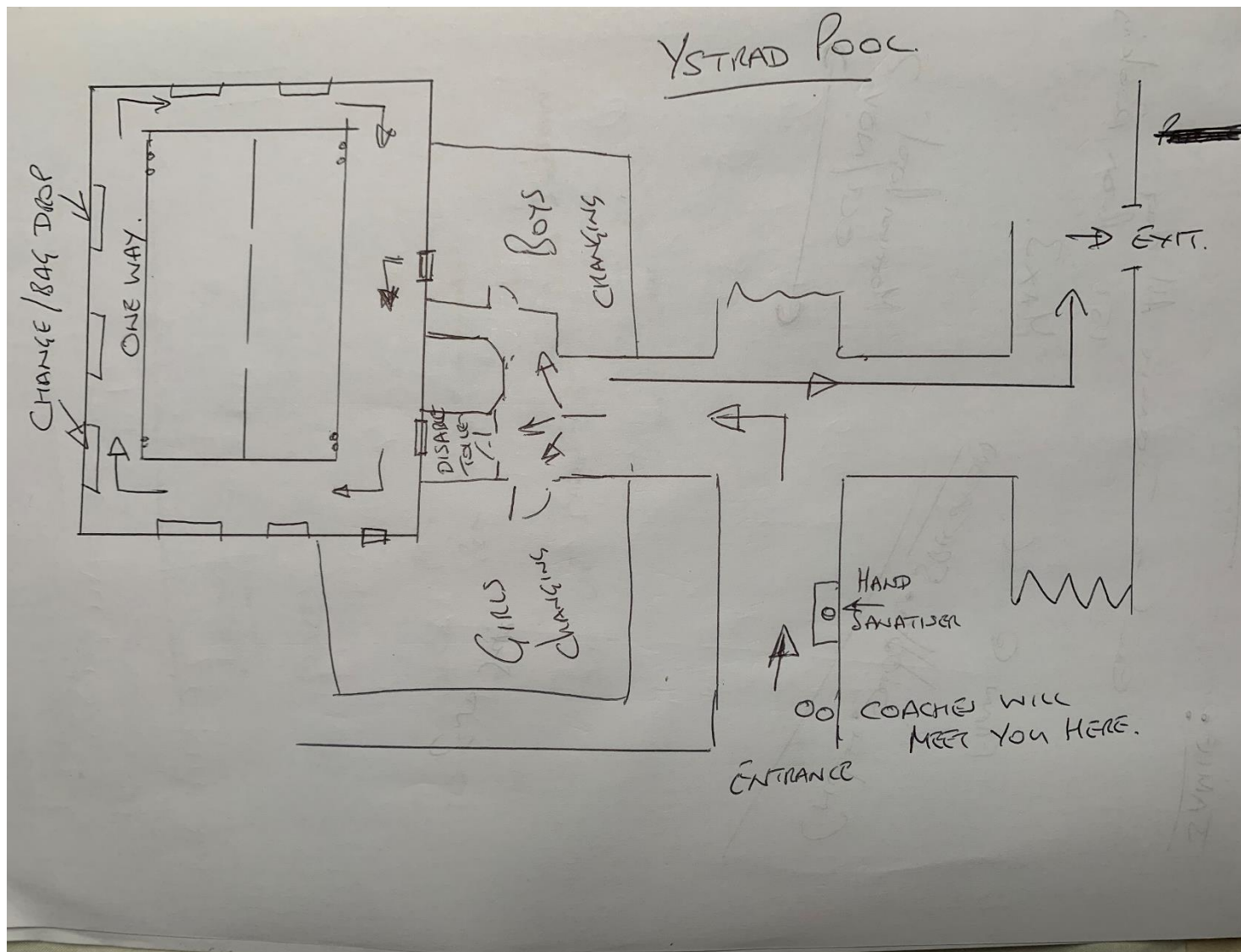

RISK ASSESSMENT FOR YSTRADGYNLAIS SWIMMING POOL



RISK ASSESSMENT FOR YSTRADGYNLAIS SWIMMING POOL